



# ENVIROCAST BENEFITS

## FOR BUILDERS -

- **Expedited Timeline of Construction**  
\* Typically set within 1 day with paint ready exterior & studded interior
- **No Cementitious Coating Required**  
\* Solid concrete doesn't need cementitious coating for water-resistance or hiding CMU
- **Downsized Mechanical Equipment**  
\* Walls with U=0.062 means less work for mechanical equipment
- **Simplified Electrical**  
\* No punching into CMU to install receptacles!
- **2- hour Fire Rating For Townhome & Multi-Family Separation Walls**  
\* A simple solution for fire separation walls between units
- **Waste Cleanup & Haul Reduction**  
\* No more CMU waste piles for disposal
- **Simplified & Reduced Jobsite Supervision**  
\* Less work of site trades due to factory pre-assembly
- **Contribution to Energy Star for 45L Tax Credit**  
\* Lower U-value, continuous insulation, tighter house - Reduced HERS index, improved Blower Door Test, and no additional insulation to meet Energy star
- **Consistency of Supply**  
\* Made in advance, pre-inspected, factory quality
- **Bucks for Windows & Doors Are Included**  
\* Structural bucks provide simpler on-site install

## FOR OWNERS -

- Significant lifecycle energy cost reduction for heating & cooling
- Cellulose elimination for everything but window bucks
- Hurricane resistance & longevity of solid concrete
- Insurance savings vs. wood frame
- Improved interior air quality
- Resilient construction
- Noise reduction

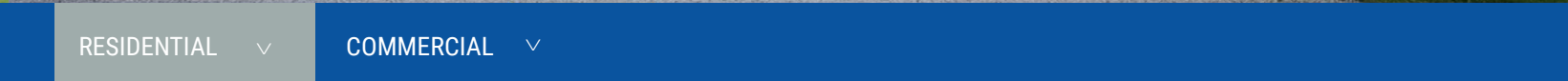
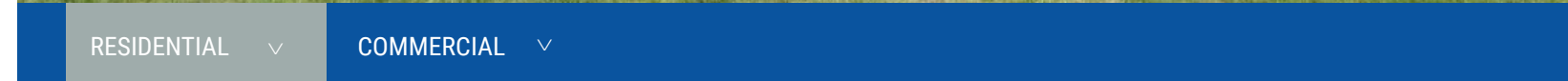
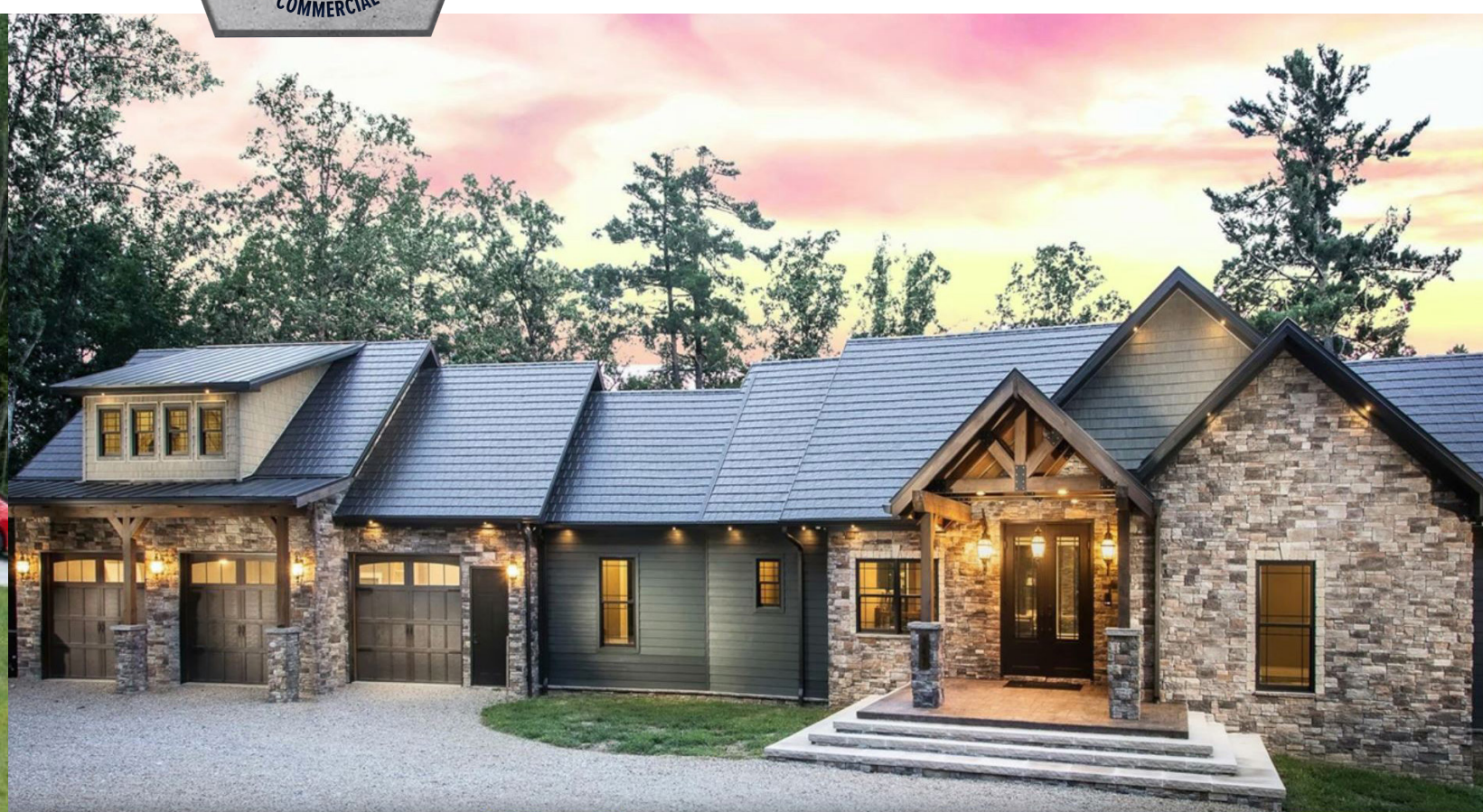

ENVIROCAST wall system is designed to increase speed of construction and reduce time to occupancy of residential homes. They feature flexible designs that are highly adaptable and can be engineered to fit a variety of applications. ENVIROCAST walls can be easily sized and configured to meet specific project requirements.

Call our ENVIROCAST technical team today for help designing your above or below grade residential wall solutions. Let our team of experts help you increase the speed of construction



CXT® is a licensee of Envirocast®, LLC.

# ENVIROCAST®

## RESIDENTIAL WALLS SINGLE FAMILY ABOVE GRADE

Florida Product# FL47168

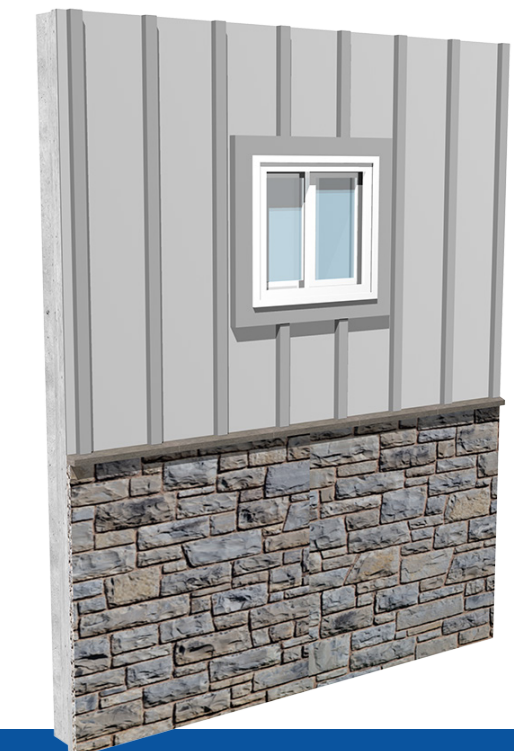

\*Stone depicted is field applied by others.



## ENVIROCAST WALL COMPONENTS

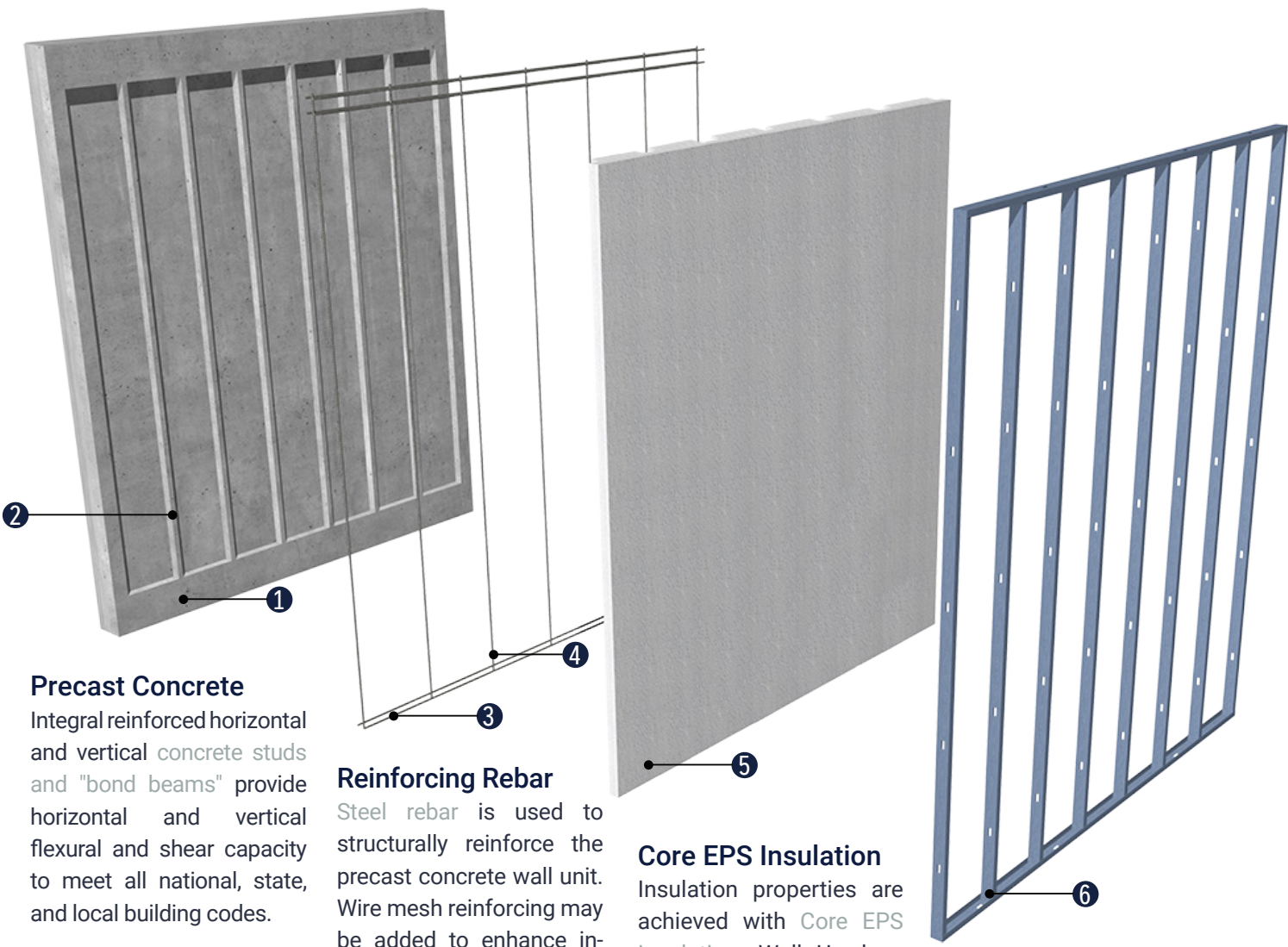

**Precast Concrete**  
Integral reinforced horizontal and vertical concrete studs and "bond beams" provide horizontal and vertical flexural and shear capacity to meet all national, state, and local building codes.

LEGEND	
1	CONCRETE FACE
2	CONCRETE STUD
3	REBAR IN BOND BEAMS
4	REBAR IN STUDS
5	EPS INSULATION
6	METAL STUD FRAME

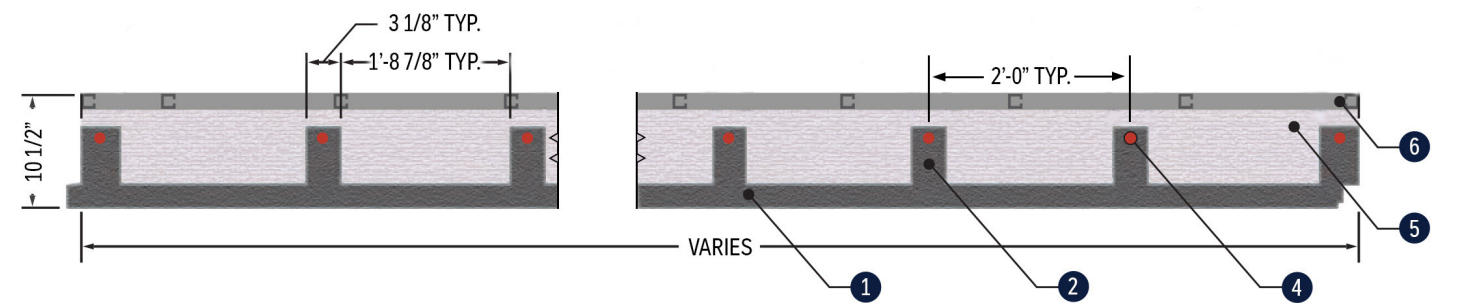

\*Actual cross section and components may vary subject to final design and local codes.

**Reinforcing Rebar**  
Steel rebar is used to structurally reinforce the precast concrete wall unit. Wire mesh reinforcing may be added to enhance in-plane shear capacity.

**Core EPS Insulation**  
Insulation properties are achieved with Core EPS Insulation. Wall U-values will vary depending on actual wall configuration, U-values comply with the latest Energy Code requirements for walls.

**Metal Stud Framing**  
20 gauge integral metal drywall studs complete the interior of the wall making it ready to receive the wall finish.

**"Durable high strength fiber reinforced walls, pre-insulated and pre-studded. Ready for electrical and drywall on the inside, ready for paint on the outside."**

# SPEED OF INSTALLATION

**"Increase Speed to Revenue by Increasing Speed of Construction."**

**2\* HOMES IN 1 DAY**

**BUILD FASTER SELL FASTER** - Due to shortages of on-site trade labor, the residential housing industry is unable to keep up with the demand for rapid home construction. Pre-fabrication greatly increases the speed of residential home construction, and shortens the time to occupancy. Construction speed makes ENVIROCAST wall systems the ideal choice for builders who need to build faster and get homes on the market sooner.

ENVIROCAST wall system is a cost effective solution that makes it possible to install walls faster than wood frame or CMU block walls.

# TRADE CONSOLIDATION

**TRADE CHALLENGES** - Concrete Masonry Unit (CMU) Construction requires multiple trades and process steps that are interdependent and time consuming. CMU trades also require valuable dedicated site space for materials, and costly time for post trade site clean up.

- CMU Construction typically includes installation of:
- Steel reinforcing protruding from base slab
  - Concrete Masonry Units
  - Steel reinforcing in CMU cavities
  - Grout within reinforced cavities and bond beams
  - Insulation in non-reinforced CMUs
  - Hurricane straps for roof trusses
  - Studs/furring strips for interior wall
  - Insulation for interior wall
  - Exterior cementitious finish or EIFS
  - Door and window rough ins
  - Punch-ins for electrical receptacles

\*Typical single-story home exterior walls can be installed in a single day.  
\*\*Listing of most common processes used in CMU construction. Actual processes used may vary.

**TIME MATTERS** - When time is a priority and quality is a requirement, builders turn to ENVIROCAST wall systems. ENVIROCAST wall systems are engineered and designed to increase speed of construction. They feature flexible designs that are highly adaptable and have been engineered to fit a variety of applications. Our walls can be easily sized to meet specific project requirements.

Large home builders, project developers, architects, engineers are embracing ENVIROCAST wall systems as an improved alternative to stick built and concrete block construction.

## SAVINGS • COMPLIANCE • STRENGTH • SUSTAINABILITY

**SAVINGS** - ENVIROCAST saves time by making it possible to install walls in a matter of hours, instead of days or weeks. A faster build means sooner to market, resulting in a rapid ROI. ENVIROCAST wall systems are plant manufactured in a quality and climate controlled environment while excavation is being performed on-site, allowing for immediate installation of walls.

Exterior walls for a small home can be installed in half a day, complete with insulation and studs for maximum efficiency.

**COMPLIANCE** - ENVIROCAST wall systems meet all local, state and national building codes. Reinforced vertical and horizontal integral concrete studs and "bond beams" provide vertical and horizontal flexural as well as shear capacity to ensure building code

**STRENGTH** - The strength, durability and fire resistance of concrete makes ENVIROCAST the ideal wall solution in areas affected by severe weather events, such as hurricanes, tornados, flooding or wildfires.

**SUSTAINABILITY** - ENVIROCAST will make significant contributions to Leadership in Energy and Environmental Design (LEED) and Home Energy Rating System (HERS) standards and complies with the latest green building practices and Energy Codes. ENVIROCAST delivers superior thermal performance depending on insulation options chosen and wall configurations.

ENVIROCAST incorporates recycled materials and up to 95 percent of ENVIROCAST materials are reclaimable and can be recycled into new structures. ENVIROCAST is designed and engineered to be the future of green building.



### "R" & "U" VALUE

R/U VALUE CERTIFICATION FOR 10 FOOT ENVIROCAST WALL SYSTEM (10 1/2" thick panel)

R-Values:		
Concrete	0.11	R/inch
EPS Insulation (@75 degrees F)	3.60	R/inch
Interior Air Film	0.68	R/inch
Exterior Air Film	0.17	R/inch
Sheetrock	0.91	R/inch

Section @ Concrete Top&Mid:	R-Values	U-Values
9.5" Concrete Rib	1.00	
1" EPS Insulation	3.60	
1" Air Film Int	0.68	
1" Air Film Ext	0.17	
Totals	5.45	0.183

Section @ Concrete Ribs:	R-Values	U-Values
7.5" Concrete Rib	0.79	
1 3/8" EPS Insulation	4.95	
1" Air Film Int	0.68	
1" Air Film Ext	0.17	
1" Air Space	0.96	
1/2" Sheet Rock	0.45	
Totals	8.01	0.125

Section @ Cavity:	R-Values	U-Values
3" Concrete Face	0.32	
5 7/8" EPS Insulation	21.15	
1" Air Film Int	0.68	
1" Air Film Ext	0.17	
1" Air Space	0.96	
1/2" Sheet Rock	0.45	
Totals	23.73	0.042

Composite U Values:		
Section @ Concrete Top x 3.02% =		.006
Section @ Concrete Ribs x 18.29% =		.023
Section @ Cavity x 78.70% =		.033
<b>*Total U Factor</b>		<b>0.062</b>
<b>*Total R Value</b>		<b>16.2</b>

\*R-Value represented is an inverse of the U-Factor calculated based on the Energy Code Compliance method for U-Factor and is presented for relative comparison only. This value should not be used to satisfy Energy Code compliance, but rather the U-Factor given.

## FINISHES

ENVIROCAST wall systems are available in a variety of finishes with a range of color and texture combinations. Finishes include float, broom, stamped brick, board & batten panel, smooth with brick tie backs, and more. ENVIROCAST walls can also be a versatile component of the building facade.

Call our ENVIROCAST Technical Team today for help designing your ENVIROCAST wall solution. Let our team of experts help you get the look you want with the performance you need.

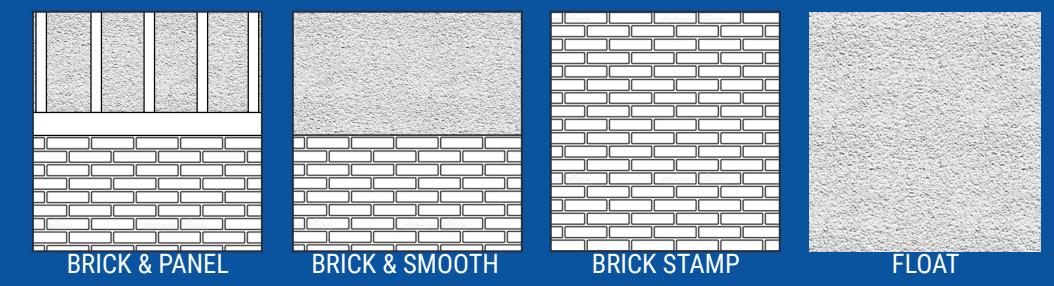

**11\*\* PROCESSES IN 1 STEP**