



CXT® Incorporated manufactures restroom, shower and concession buildings in multiple designs, textures, and colors. The roof and walls are fabricated with high strength precast concrete to meet all local building codes and textured to match local architectural details. All CXT buildings are designed to meet A.D.A. and to withstand heavy snow, high wind, and category E seismic loads. All concrete construction also makes the buildings easy to maintain and withstand the rigors of vandalism. The buildings are prefabricated and delivered complete and ready-to-use, including plumbing and electrical where applicable. With thousands of satisfied customers nationwide, CXT is the leader in prefabricated concrete restrooms.

**GSA CONTRACT INFORMATION:**

**SCHEDULE TITLE:**

056-Buildings and Building Material/Industrial Services and Supplies

FSC Group 54- Pre-engineered/Prefabricated Buildings and Structures

FSC CLASS: 5410

CONTRACT NUMBER: 47QSWA23D009W

CONTRACT PERIOD: September 18, 2023 through September 17, 2028

CONTRACTOR'S NAME ADDRESS TELEPHONE AND FAX NUMBER E-MAIL AND/OR WEBSITE ADDRESS:

CXT Incorporated  
606 N. Pines Road, Suite 202  
Spokane Valley, WA 99206  
Toll free: 800-696-5766  
Fax: 509-928-8270  
E-mail: sales@lbfoster.com

CONTRACTOR'S ADMINISTRATION SOURCE: Gary Burger, director of commercial operations.

BUSINESS SIZE/TYPE: Other than small business.

DELIVERY INFORMATION: All prices F.O.B. Origin prepaid and added to invoice. CXT operates three (3) manufacturing plants in the United States and will deliver from the closest location on our carriers. Use the following chart to determine the origin.

F.O.B. 6701 E. Flamingo Avenue, Building 300, Nampa, ID 83687 applies to: AK, AZ, CA, CO, HI, ID, MT, ND, NV, OR, SD, UT, WA, WY.

F.O.B. 901 North Highway 77, Hillsboro, TX 76645 applies to AL, AR, AZ, CO, CT, DE, FL, GA, IA, IL, IN, KS, KY, LA, MA, MD, ME, MI, MN, MO, MS, NC, NE, NH, NJ, NM, NY, OH, OK, PA, PR, RI, SC, TN, TX, VA, VT, WI, WV.

F.O.B. 362 Waverly Road, Williamstown, WV 26183 applies to AL, CT, DE, FL, GA, IL, IN, KY, MA, MD, ME, MI, NC, NH, NJ, NY, OH, PA, PR, RI, SC, TN, VA, VT, WI, WV.

**1a. TABLE OF AWARDED SPECIAL ITEM NUMBERS (SIN's) WITH APPROPRIATE CROSS-REFERENCE TO PAGE NUMBER(S):**

SIN	DESCRIPTION
332311P	Precast concrete buildings including accessories and options.
OLM	Order Level Materials

**1b. IDENTIFICATION OF THE LOWEST PRICED MODEL NUMBER AND PRICE FOR EACH SIN: (Government net price based on a unit of one,**

exclusive of any quantity/ dollar volume, prompt payment, or any other concession affecting price).

SIN	MODEL/DESCRIPTION	NET GSA PRICE
332311P	Gunnison/Single Vault	\$22,825.99

- 1c. HOURLY RATES: N/A
- 2. MAXIMUM ORDER PER SIN 332311P: Zero.
- 3. MINIMUM ORDER: None.
- 4. GEOGRAPHIC COVERAGE (delivery area): The 50 states, D.C., Puerto Rico, and U.S. territories.
- 5. POINT(S) OF PRODUCTION:
  - CXT Incorporated, 901 North Highway 77, Hillsboro TX 76645, Hill County.
  - CXT Incorporated, 6701 E. Flamingo Avenue, Building 300, Nampa, ID 83687, Canyon County.
  - CXT Incorporated, 362 Waverly Road, Williamstown, WV 26183, Wood County.
- 6. DISCOUNT FROM LIST PRICES OR STATEMENT OF NET PRICE: Prices shown are net. Prices exclude all federal/state/local taxes. Tax will be charged where applicable if customer is unable to provide proof of exemption.
- 7. QUANTITY DISCOUNT(S): One percent (1%) additional on single orders \$250,000 to \$749,999. Two percent (2%) on single orders over \$750,000.
- 8. PROMPT PAYMENT TERMS: Payment to CXT by the purchaser shall be made net 30 days after the submission of the invoice to the purchaser. Interest at a rate equal to the lower of (i) the highest rate permitted by law; or (ii) 1.5% per month will be charged monthly on all unpaid invoices beginning the 35th day (includes (five) 5-day grace period) from the date of the invoice. Under no circumstances can a retention be taken and purchaser shall pay the full invoiced amount without offset or reduction.
- 9a. NOTIFICATION THAT GOVERNMENT PURCHASE CARDS ARE ACCEPTED BELOW THE MICROPURCHASE THRESHOLD: Visa, MasterCard, and American Express.
- 9b. NOTIFICATION WHETHER GOVERNMENT PURCHASE CARDS ARE ACCEPTED OR NOT ACCEPTED ABOVE THE MICROPURCHASE THRESHOLD: Visa, MasterCard accepted above the micropurchase threshold.
- 10. FOREIGN ITEMS: None.
- 11a. TIME OF DELIVERY: 120 days ARO.
- 11b. EXPEDITED DELIVERY: Contact vendor.
- 11c. OVERNIGHT AND 2-DAY DELIVERY: None.



- 11d. URGENT DELIVERY: None.
12. FOB POINT(S): FOB origin -prepay and add.
- 13a. ORDERING ADDRESS(ES): CXT Incorporated, 606 N. Pines Road, Suite 202, Spokane Valley, WA 99206.
- 13b. ORDERING PROCEDURES: Fax GSA Purchase Order to (509) 928-8270.
14. PAYMENT ADDRESS(ES):  
**Remitting by check:**  
CXT, Inc., PO Box 676208, Dallas, TX 75267-6208  
**Remitting by ACH or wire transfer:**  
Beneficiary: CXT, Inc. Beneficiary Bank: PNC Bank, Pittsburgh, PA Account: 1077766885 ABA/Routing: 043000096 Email remittance details to AR@lbfoster.com
15. WARRANTY PROVISIONS: CXT provides a one (1) year warranty. The warranty is valid only when concrete is used within the specified loadings. Furthermore, said warranty includes only the related material necessary for the construction and fabrication of said concrete components. All other non-concrete components will carry a one (1) year warranty. CXT warrants that all goods sold pursuant hereto will, when delivered, conform to specifications set forth above. Goods shall be deemed accepted and meeting specifications unless notice identifying the nature of any non-conformity is provided to CXT in writing within the specified warranty. CXT, at its option, will repair or replace the goods or issue credit for the customer provided CXT is first given the opportunity to inspect such goods. It is specifically understood that CXT's obligation hereunder is for credit, repair, or replacement only, F.O.B. CXT's manufacturing plants, and does not include shipping, handling, installation or other incidental or consequential costs unless otherwise agreed to in writing by CXT.
16. EXPORT PACKING CHARGES: N/A
17. TERMS AND CONDITIONS OF GOVERNMENT PURCHASE CARD ACCEPTANCE: Government purchase cards will be accepted on all orders.
18. TERMS AND CONDITIONS OF RENTAL, MAINTENANCE AND REPAIR (IF APPLICABLE): N/A
19. TERMS AND CONDITIONS OF INSTALLATION (IF APPLICABLE): Customers are responsible for marking exact location building is to be set; providing clear and level site, free of overhead and/or underground obstructions; and providing site accessible to normal highway trucks and sufficient area for the crane to install and other equipment to perform the contract requirements. Site must allow for the crane to be within three feet of the building location and the truck to be within three feet of the crane. Customer shall provide notice in writing of low bridges, roadway width or grade, unimproved roads, or any other possible obstacles to access. CXT reserves the right to charge the customer for additional costs incurred for special equipment required to perform delivery and installation. Customer is responsible for all building permits required and compliance with Davis-Bacon Requirements. Customers will negotiate installation on a project-by-project basis, which shall be priced as separate line items. For more information regarding installation and truck turning radius guidelines please see our website at [www.cxtinc.com](http://www.cxtinc.com).
- 20a. TERMS AND CONDITIONS OF REPAIR PARTS INDICATING DATE

- OF PARTS PRICE LISTS AND ANY DISCOUNTS FROM LIST PRICES (IF APPLICABLE): List of repair parts available upon request.
- 20b. TERMS AND CONDITIONS FOR ANY OTHER SERVICES (IF APPLICABLE): N/A
- 21 LIST OF SERVICE AND DISTRIBUTION POINTS (IF APPLICABLE): N/A
22. LIST OF PARTICIPATING DEALERS (IF APPLICABLE): N/A
23. PREVENTATIVE MAINTENANCE: Maintenance manuals available online at [www.cxtinc.com](http://www.cxtinc.com). Printed manuals available by request by calling (800) 696-5766.
- 24a. SPECIAL ATTRIBUTES SUCH AS ENVIRONMENTAL ATTRIBUTES: N/A
- 24b. SECTION 508 COMPLIANCE: N/A
25. DATA UNIVERSAL NUMBER SYSTEM (DUNS) NUMBER: 157004896. UEI NUMBER: MLC1FHL356S9.
26. NOTIFICATION REGARDING REGISTRATION IN CENTRAL CONTRACTOR REGISTRATION (CCR) DATABASE: Cage Code OGA05.



# FONTANA – 10' x 26'

Fontana concession building with standard features that include simulated barnwood textured walls, simulated cedar shake textured roof, interior and exterior lights, 30-gallon water heater, three-compartment stainless steel sink, roll up concession window, off loaded, and set up at site.

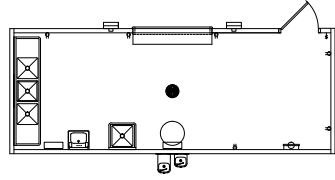

**CXT**  
800.696.5766  
cxtinc.com

		Price Per Unit	
<b>Base Price</b>		\$	\$
<b>OLM Items</b>		Click to Select	
Final Connection to Utilities		\$	
Optional Wall Texture- <i>choose one</i>	Split Face Block      Stone		
Optional Roof Texture	Ribbed Metal	\$	
Insulation and Heater		\$	
Skylight (each)	Qty:	\$	
Marine Grade Skylight (each)	Qty:	\$	
Marine Package (excluding fiberglass doors and frames)		\$	
Stainless Steel Lavatory (each)	Qty:	\$	
Composite Mop Sink (each)	Qty:	\$	
2K Anti-Graffiti Coating		\$	
Optional Door Closure		\$	
Fiberglass Door and Frame		\$	
Timed Electric Lock System		\$	
<b>Total for Added Cost Options:</b>			\$
Custom Options:			\$
Engineering and State Fees:			\$
Estimated One-Way Transportation Costs to Site (quote):			\$
Estimated Tax:			\$
<b>Total Cost per Unit Placed at Job Site:</b>			\$

*Estimated monthly payment on 5 year lease*



This price quote is good for 60 days from date below, and is accurate and complete.

CXT Sales Representative \_\_\_\_\_ Date \_\_\_\_\_

I accept this quote. Please process this order.

Company Name \_\_\_\_\_

Company Representative \_\_\_\_\_ Date \_\_\_\_\_

# MALIBU – 25' 8" x 26' 4"

Malibu with chase has two multiuser restrooms and a concession. Standard features include simulated barnwood textured walls, simulated cedar shake textured roof, interior and exterior lights, vitreous china fixtures in restrooms, 30-gallon water heater, three compartment stainless steel sink in concession area, roll-up concession window, off loaded, and set up at site.



**CXT**  
800.696.5766  
cxtinc.com

			Price Per Unit	
Base Price			\$	\$
OLM Items			Click to Select	
Final Connection to Utilities (per section)			\$	
Optional Wall Texture (per section)- <i>choose one</i>	Split Face Block	Stone		
Optional Roof Texture (per section)	Ribbed Metal		\$	
"Front Porch" Style Privacy Screen			\$	
Insulation and Heaters (per section)			\$	
Stainless Steel Water Closet (each)	Qty:		\$	
Stainless Steel Lavatory (each)	Qty:		\$	
Stainless Steel Urinal (each)	Qty:		\$	
Electric Hand Dryer (each)	Qty:		\$	
Electronic Flush Valve (each)	Qty:		\$	
Electronic Lavatory Faucet (each)	Qty:		\$	
Electronic Urinal Valve (each)	Qty:		\$	
Paper Towel Dispenser (each)	Qty:		\$	
Toilet Seat Cover Dispenser (each)	Qty:		\$	
Sanitary Napkin Disposal Receptacle (each)	Qty:		\$	
Baby Changing Table (each)	Qty:		\$	
Skylight in Restroom (each)	Qty:		\$	
Marine Grade Skylight in Restroom (each)	Qty:		\$	
Stainless Steel Lavatory in Concession (each)	Qty:		\$	
Composite Mop Sink in Concession (each)	Qty:		\$	
Marine Package ( <i>except for fiberglass doors and frames</i> ) (per section)			\$	
Exterior Mounted ADA Drinking Fountain w/Cane Skirt (each)	Qty:		\$	
2K Anti-Graffiti Coating (per section)			\$	
Optional Door Closure (each)	Qty:		\$	
Fiberglass Entry and Chase Doors and Frames (each)	Qty:		\$	
Timed Electric Lock System (2 doors- does not include chase door) (each)	Qty:		\$	
Exterior Frostproof Hose Bib with Box (each)	Qty:		\$	
Total for Added Cost Options:			\$	
Custom Options:			\$	
Engineering and State Fees:			\$	
Estimated One-Way Transportation Costs to Site (quote):			\$	
Estimated Tax:			\$	
Total Cost per Unit Placed at Job Site:			\$	

*Estimated monthly payment on 5 year lease*

This price quote is good for 60 days from date below, and is accurate and complete.

CXT Sales Representative

Date

I accept this quote. Please process this order.



Company Name

Company Representative

Date

# POMONA – 30' x 26'

Pomona with chase has two multiuser restrooms with a concession. Standard features include simulated barnwood textured walls, simulated cedar shake textured roof, interior and exterior lights, vitreous china fixtures in restrooms, 30-gallon water heater, three compartment stainless steel sink in concession area, roll-up concession window, off loaded, and set up at site.

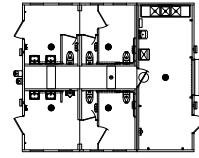

**CXT**  
800.696.5766  
cxtinc.com

		Price Per Unit	
<b>Base Price</b>		\$	\$
<b>OLM Items</b>		Click to Select	
Final Connection to Utilities (per section)		\$	
Optional Wall Texture (per section) - <i>choose one</i>	Split Face Block                      Stone		
Optional Roof Texture (per section)	Ribbed Metal	\$	
Insulation and Heaters (per section)		\$	
Stainless Steel Water Closet (each)	Qty:	\$	
Stainless Steel Lavatory (each)	Qty:	\$	
Stainless Steel Urinal (each)	Qty:	\$	
Electric Hand Dryer (each)	Qty:	\$	
Electronic Flush Valve (each)	Qty:	\$	
Electronic Lavatory Faucet (each)	Qty:	\$	
Electronic Urinal Valve (each)	Qty:	\$	
Paper Towel Dispenser (each)	Qty:	\$	
Toilet Seat Cover Dispenser (each)	Qty:	\$	
Sanitary Napkin Disposal Receptacle (each)	Qty:	\$	
Baby Changing Table (each)	Qty:	\$	
Skylight in Restroom (each)	Qty:	\$	
Marine Grade Skylight in Restroom (each)	Qty:	\$	
Stainless Steel Lavatory in Concession (each)	Qty:	\$	
Composite Mop Sink in Concession (each)	Qty:	\$	
Marine Package ( <i>excluding fiberglass doors and frames</i> ) (per section)		\$	
Exterior Mounted ADA Drinking Fountain w/Cane Skirt (each)	Qty:	\$	
2K Anti-Graffiti Coating (per section)		\$	
Optional Door Closure (each)	Qty:	\$	
Fiberglass Entry and Chase Doors and Frames (each)		Qty:	\$
Timed Electric Lock System (2 doors- does not include chase door) (each)		Qty:	\$
Exterior Frostproof Hose Bib with Box (each)	Qty:	\$	
Total for Added Cost Options:		\$	
Custom Options:		\$	
Engineering and State Fees:		\$	
Estimated One-Way Transportation Costs to Site (quote):		\$	
Estimated Tax:		\$	
<b>Total Cost per Unit Placed at Job Site:</b>		<b>\$</b>	

*Estimated monthly payment on 5 year lease*

This price quote is good for 60 days from date below, and is accurate and complete.

I accept this quote. Please process this order.



Company Name

CXT Sales Representative

Date

Company Representative

Date

## OPTIONS

**Exterior Color(s)** (For single color mark an X. For two-tone combinations use W = Walls and R = Roof.)

<input type="checkbox"/> Amber Rose	<input type="checkbox"/> Berry Mauve	<input type="checkbox"/> Buckskin	<input type="checkbox"/> Cappuccino Cream
<input type="checkbox"/> Charcoal Grey	<input type="checkbox"/> Coca Milk	<input type="checkbox"/> Evergreen	<input type="checkbox"/> Georgia Brick
<input type="checkbox"/> Golden Beige	<input type="checkbox"/> Granite Rock	<input type="checkbox"/> Hunter Green	<input type="checkbox"/> Java Brown
<input type="checkbox"/> Liberty Tan	<input type="checkbox"/> Malibu Taupe	<input type="checkbox"/> Mocha Caramel	<input type="checkbox"/> Natural Honey
<input type="checkbox"/> Nuss Brown	<input type="checkbox"/> Oatmeal Buff	<input type="checkbox"/> Pueblo Gold	<input type="checkbox"/> Raven Black
<input type="checkbox"/> Rich Earth	<input type="checkbox"/> Rosewood	<input type="checkbox"/> Sage Green	<input type="checkbox"/> Salsa Red
<input type="checkbox"/> Sand Beige	<input type="checkbox"/> Sun Bronze	<input type="checkbox"/> Toasted Almond	<input type="checkbox"/> Western Wheat

Special roof color # \_\_\_\_\_ Special wall color # \_\_\_\_\_

Special trim color # \_\_\_\_\_

**Stone Color**(Mark option with an X.)

<input type="checkbox"/> Basalt	<input type="checkbox"/> Mountain Blend	<input type="checkbox"/> Natural Grey	<input type="checkbox"/> Romana
---------------------------------	---	---------------------------------------	---------------------------------

**Roof Texture**

Ribbed Metal

**Wall Texture(s)** (For single texture mark an X. For top and bottom textures use T = Top and B = Bottom.)

<input type="checkbox"/> Split Face Block	<input type="checkbox"/> Horizontal Lap	<input type="checkbox"/> Board & Batt	<input type="checkbox"/> Stucco
<input type="checkbox"/> Brick	<input type="checkbox"/> Distressed Wood		

**Stone Wall Texture**(bottom texture only)

<input type="checkbox"/> Napa Valley	<input type="checkbox"/> River Rock	<input type="checkbox"/> Flagstone	<input type="checkbox"/> Stacked Rock
--------------------------------------	-------------------------------------	------------------------------------	---------------------------------------

**Door Opener**

Non-locking ADA Handle

Privacy ADA Latch

Pull Handle/Push Plate

**Deadbolt**

**Accessible Signage**

Men

Women

Unisex

**Toilet Paper Holder**

2-Roll Stainless Steel

3-Roll Stainless Steel

**Notes:**

cxtinc.com  
800.696.5766

